



STOW POLICE DEPARTMENT
 PRIVATE PROPERTY ACCIDENT REPORT/MINOR
 TRAFFIC ACCIDENT REPORT

INCIDENT NUMBER **25-08309**
 DATE **5/14/25** TIME **1435**

Private Property Private Property - Hit/Skip Minor Traffic Accident

LOCATION - ADDRESS
4290 KENT RD.

DRIVER #1 - NAME (Last, First, Middle) **DUNCAN, LAUREN, NICOLE** PHONE **(815) 302-2202**

ADDRESS **113 SAPPHIRE LN.** CITY **STREETSBORO** STATE **OH** ZIP **44241**

SSN [REDACTED] DATE OF BIRTH **9/7/1983** DRIVER'S LICENSE NUMBER [REDACTED] STATE **OH**

OWNER #1 - NAME (Last, First, Middle) SAME AS DRIVER #1 PHONE

ADDRESS CITY STATE ZIP

SSN DATE OF BIRTH DRIVER'S LICENSE NUMBER STATE

VEHICLE LICENSE # **KNC8791** STATE **OH** YEAR **2024** MAKE **JEEP** MODEL **WAGONEER** COLOR **BLACK**

INSURANCE COMPANY **TRAVELERS INS.** POLICY NUMBER **605755496-203-1**

PARTS OF VEHICLE DAMAGED **REAR PASSENGER SIDE** CONTRIBUTING CIRCUMSTANCES **IMPROPER BACKING**

DRIVER #2 - NAME (Last, First, Middle) **ROTHERMEL, SHERI, LYNN** PHONE **(330) 502-0041**

ADDRESS **5960 APPLECREST DR.** CITY **BOARDMAN** STATE **OH** ZIP **44512**

SSN [REDACTED] DATE OF BIRTH **10/7/1967** DRIVER'S LICENSE NUMBER [REDACTED] STATE **OH**

OWNER #2 - NAME (Last, First, Middle) SAME AS DRIVER #2 PHONE

ADDRESS CITY STATE ZIP

SSN DATE OF BIRTH DRIVER'S LICENSE NUMBER STATE

VEHICLE LICENSE # **KET3570** STATE **OH** YEAR **2014** MAKE **AUDI** MODEL **A6** COLOR **DARK BLUE**

INSURANCE COMPANY **ALLSTATE** POLICY NUMBER **826 896 908**

PARTS OF VEHICLE DAMAGED **REAR DRIVER SIDE** CONTRIBUTING CIRCUMSTANCES **IMPROPER BACKING**

DESCRIBE WHAT HAPPENED
UNITS #1 & #2 WERE BOTH PARKED IN PARKING SPOTS NEAR 4290 KENT RD. BOTH UNITS ATTEMPTED TO BACK OUT OF THEIR SPOTS AT THE SAME TIME. AS A RESULT, THE REAR PASSENGER SIDE OF UNIT #1 STRUCK THE REAR DRIVER SIDE OF UNIT #2.

See Reverse Side for Diagram

SUBMITTED BY: **Pt. Registrar #754**

DATE **5/19/25**

APPROVING OFFICER: **Ginther, 715**

DATE **5-19-25**

STOW POLICE DEPARTMENT

FIELD SKETCH (not drawn to scale)

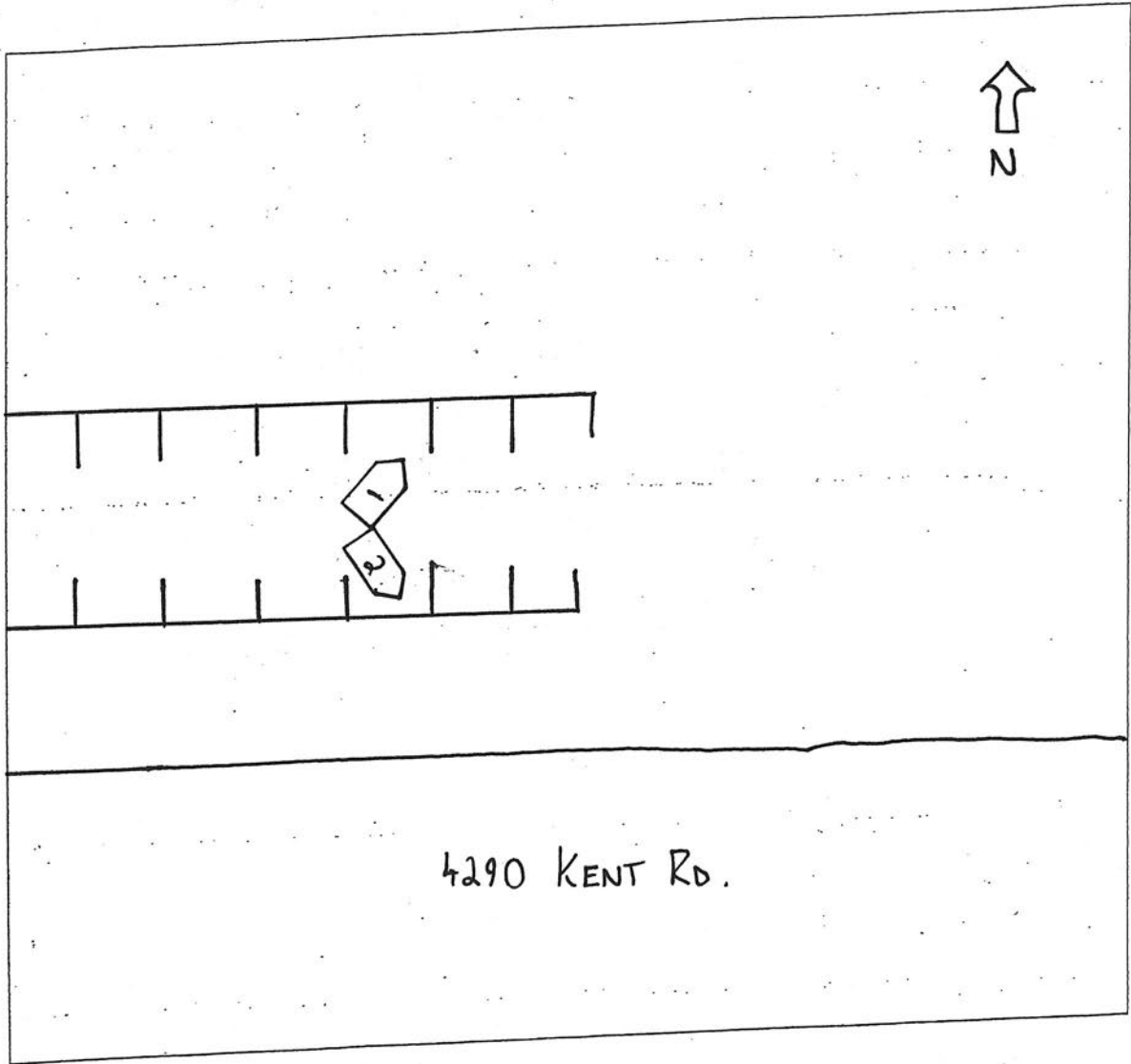

WEATHER

- CLEAR
- RAIN
- SNOW
- FOG
- OTHER

LIGHT

- DAYLIGHT
- DAWN
- DUSK
- DARK - LIGHTED ROAD
- DARK - NOT LIGHTED
- DARK - UNK LIGHTING
- UNKNOWN

SURFACE

- DRY
- WET
- SNOW
- ICE
- OTHER

ROAD

- CONCRETE
- BLACKTOP
- DIRT
- OTHER