



# STOW POLICE DEPARTMENT

## PRIVATE PROPERTY ACCIDENT REPORT/MINOR TRAFFIC ACCIDENT REPORT

INCIDENT NUMBER

25-07502

DATE

5-1-25

TIME

1523

 Private Property  Private Property - Hit/Skip  Minor Traffic Accident

LOCATION - ADDRESS

4161 Steels Pointe (Los Girasoles) Stow, OH 44224

DRIVER #1 - NAME (Last, First, Middle)

N/A

PHONE

ADDRESS

CITY

STATE

ZIP

SSN

DATE OF BIRTH

DRIVER'S LICENSE NUMBER

STATE

VEHICLE #1

OWNER #1 - NAME (Last, First, Middle)  SAME AS DRIVER #1

Hannah, Guy, Stephen

PHONE

330-400-9992

ADDRESS

3143 Dover Road

CITY

Silver Lake

STATE

OH

ZIP

44224

SSN

DATE OF BIRTH

1-7-59

DRIVER'S LICENSE NUMBER

STATE

OH

VEHICLE LICENSE#

GSE1778

STATE

OH

YEAR

2020

MAKE

HYUN

MODEL

Santa Fe

COLOR

Silver

INSURANCE COMPANY

Nationwide

POLICY NUMBER

9234J042678

PARTS OF VEHICLE DAMAGED

Rear driver-side corner

CONTRIBUTING CIRCUMSTANCES

None

DRIVER #2 - NAME (Last, First, Middle)

Lopez, Cristina Lopez

PHONE

330-400-0820

ADDRESS

1101 E. Archwood Ave.

CITY

Akron

STATE

OH

ZIP

44306

SSN

DATE OF BIRTH

7-22-01

DRIVER'S LICENSE NUMBER

STATE

VEHICLE #2

OWNER #2 - NAME (Last, First, Middle)  SAME AS DRIVER #2

Rivera Roofing

PHONE

440-687-5670

ADDRESS

4574 Northland Square Dr. W.

CITY

Columbus

STATE

OH

ZIP

43231

SSN

DATE OF BIRTH

DRIVER'S LICENSE NUMBER

STATE

VEHICLE LICENSE#

KCF8621

STATE

OH

YEAR

2017

MAKE

Chev.

MODEL

Suburban

COLOR

Black

INSURANCE COMPANY

Trexis

POLICY NUMBER

11-34-018229363

PARTS OF VEHICLE DAMAGED

Front passenger-side bumper

CONTRIBUTING CIRCUMSTANCES

Fail to control - struck parked car

DESCRIBE WHAT HAPPENED

Unit #1 was parked. Unit #2 attempted to pull into the parking space next to Unit #1. Unit #2 struck the rear driver-side of Unit #1. Unit #2 only had a Mexican passport for identification. Neither had a current version of their insurance present.

See Reverse Side for Diagram

SUBMITTED BY:

Ginther 715

DATE

5-1-25

APPROVING OFFICER:

Ginther 715

DATE

5-1-25

# STOW POLICE DEPARTMENT

## FIELD SKETCH (not drawn to scale)

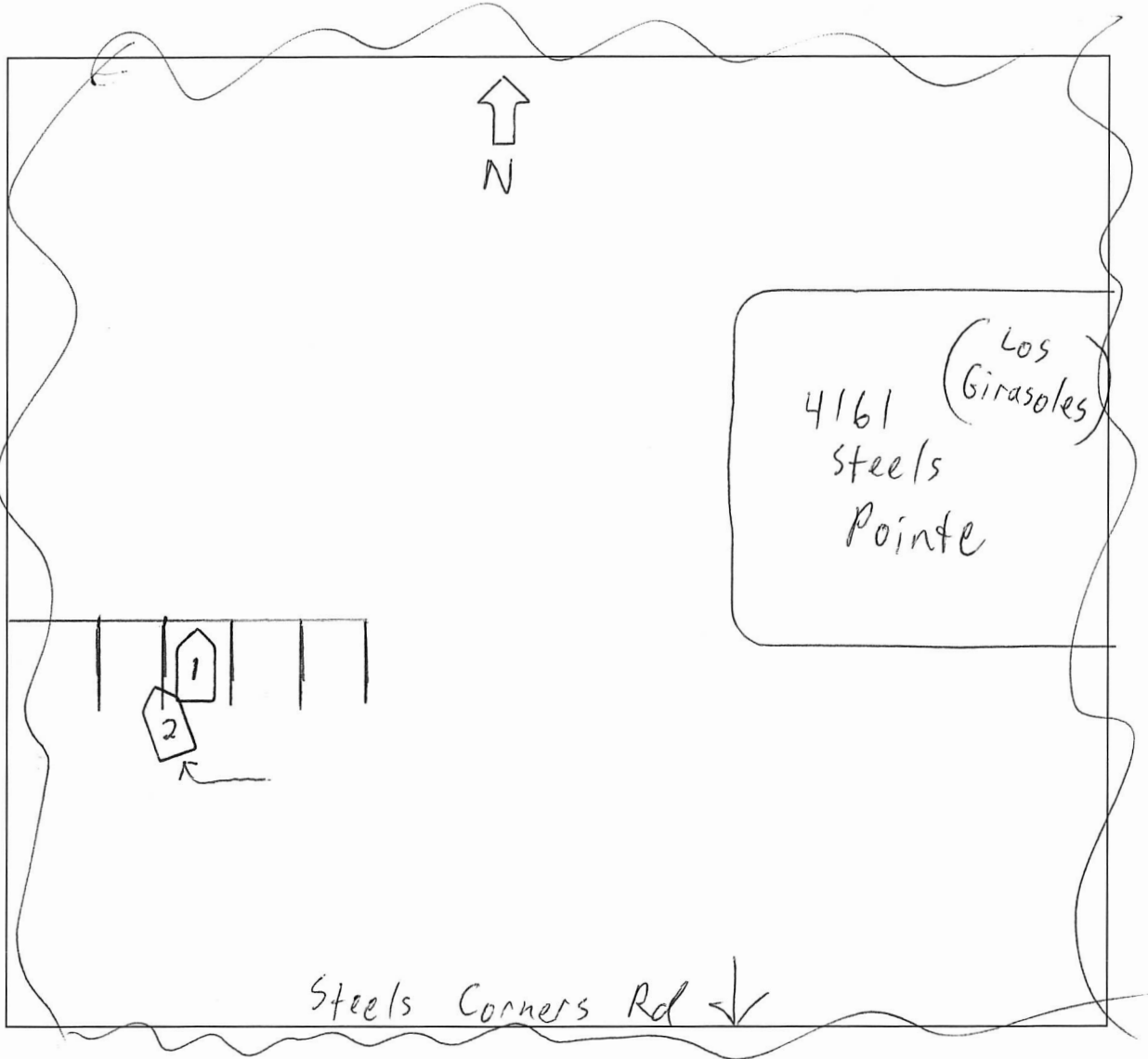

### WEATHER

- CLEAR
- RAIN
- SNOW
- FOG
- OTHER

### LIGHT

- DAYLIGHT
- DAWN
- DUSK
- DARK - LIGHTED ROAD
- DARK - NOT LIGHTED
- DARK - UNK LIGHTING
- UNKNOWN

### SURFACE

- DRY
- WET
- SNOW
- ICE
- OTHER

### ROAD

- CONCRETE
- BLACKTOP
- DIRT
- OTHER

|                                    |                             |                                   |
|------------------------------------|-----------------------------|-----------------------------------|
| LOCAL REPORT NUMBER<br>2025-007502 | REPORTING AGENCY<br>Stow PD | DATE OF CRASH<br>M 5   D 1   Y 25 |
|------------------------------------|-----------------------------|-----------------------------------|

**FOR LOCAL USE ONLY – DO NOT SUBMIT TO THE STATE EXCEPT FOR FATAL CRASHES**

I, \_\_\_\_\_ HEREBY MAKE THIS VOLUNTARY STATEMENT TO  
PRINTED  
 A. Williams AT 4161 Steels Pt  
OFFICER'S NAME LOCATION

Mary Hannah  
 3149 Dover Rd  
 Silver Lake OH 44224  
 330-400-9992

I parked my car, a black Suburban pulled in the next parking space to the left of me. She pulled back out and hit my left back bumper of my car. She offered me money to take care of it. I refused and called 911.

|  |  |
|--|--|
| ADDRESS OF WITNESS                           | PHONE<br>330-400-9992                            |
| SIGNATURE OF WITNESS<br>X <i>Mary Hannah</i> | OFFICER'S SIGNATURE<br>X <i>H. Williams</i> #768 |