



STOW POLICE DEPARTMENT

PRIVATE PROPERTY ACCIDENT REPORT/MINOR
TRAFFIC ACCIDENT REPORT

INCIDENT NUMBER
25-5230

DATE **3/26/25** TIME **0147**

Private Property Private Property - Hit/Skip Minor Traffic Accident

LOCATION - ADDRESS
1359 Housley Rd Stow, OH 44224

DRIVER #1 - NAME (Last, First, Middle) **Baker, Shawn** 765 PHONE **330-689-5700**

ADDRESS **3800 Darrow Rd** CITY **Stow** STATE **OH** ZIP **44224**

SSN _____ DATE OF BIRTH _____ DRIVER'S LICENSE NUMBER _____ STATE _____

VEHICLE #1

OWNER #1 - NAME (Last, First, Middle) SAME AS DRIVER #1 **City of Stow** PHONE **330-689-5700**

ADDRESS **3800 Darrow Rd** CITY **Stow** STATE **OH** ZIP **44224**

SSN _____ DATE OF BIRTH _____ DRIVER'S LICENSE NUMBER _____ STATE _____

VEHICLE LICENSE# **13** STATE _____ YEAR **2023** MAKE **Dodge** MODEL **CHARGER** COLOR **BLK**

INSURANCE COMPANY **WICKERT** POLICY NUMBER **52007145**

PARTS OF VEHICLE DAMAGED **FRONT PUSH BAR BENT** CONTRIBUTING CIRCUMSTANCES **NONE**

DRIVER #2 - NAME (Last, First, Middle) _____ PHONE _____

ADDRESS _____ CITY _____ STATE _____ ZIP _____

SSN _____ DATE OF BIRTH _____ DRIVER'S LICENSE NUMBER _____ STATE _____

VEHICLE #2

OWNER #2 - NAME (Last, First, Middle) SAME AS DRIVER #2 _____ PHONE _____

ADDRESS _____ CITY _____ STATE _____ ZIP _____

SSN _____ DATE OF BIRTH _____ DRIVER'S LICENSE NUMBER _____ STATE _____

VEHICLE LICENSE # _____ STATE _____ YEAR _____ MAKE _____ MODEL _____ COLOR _____

INSURANCE COMPANY _____ POLICY NUMBER _____

PARTS OF VEHICLE DAMAGED _____ CONTRIBUTING CIRCUMSTANCES _____

DESCRIBE WHAT HAPPENED
UNIT #1 (CRUISER 13) WAS TRAVELING WESTBOUND ON HOUSLEY RD WHEN A DEER CAME IN TO THE ROAD FROM THE SOUTH SIDE; NEAR 1359 HOUSLEY RD. UNIT #1 STRUCK THE DEER, CAUSING MINOR DAMAGE.

See Reverse Side for Diagram

SUBMITTED BY: 716 DATE **3/26/25**

APPROVING OFFICER: 718 DATE **3/26/25**

STOW POLICE DEPARTMENT

FIELD SKETCH (not drawn to scale)

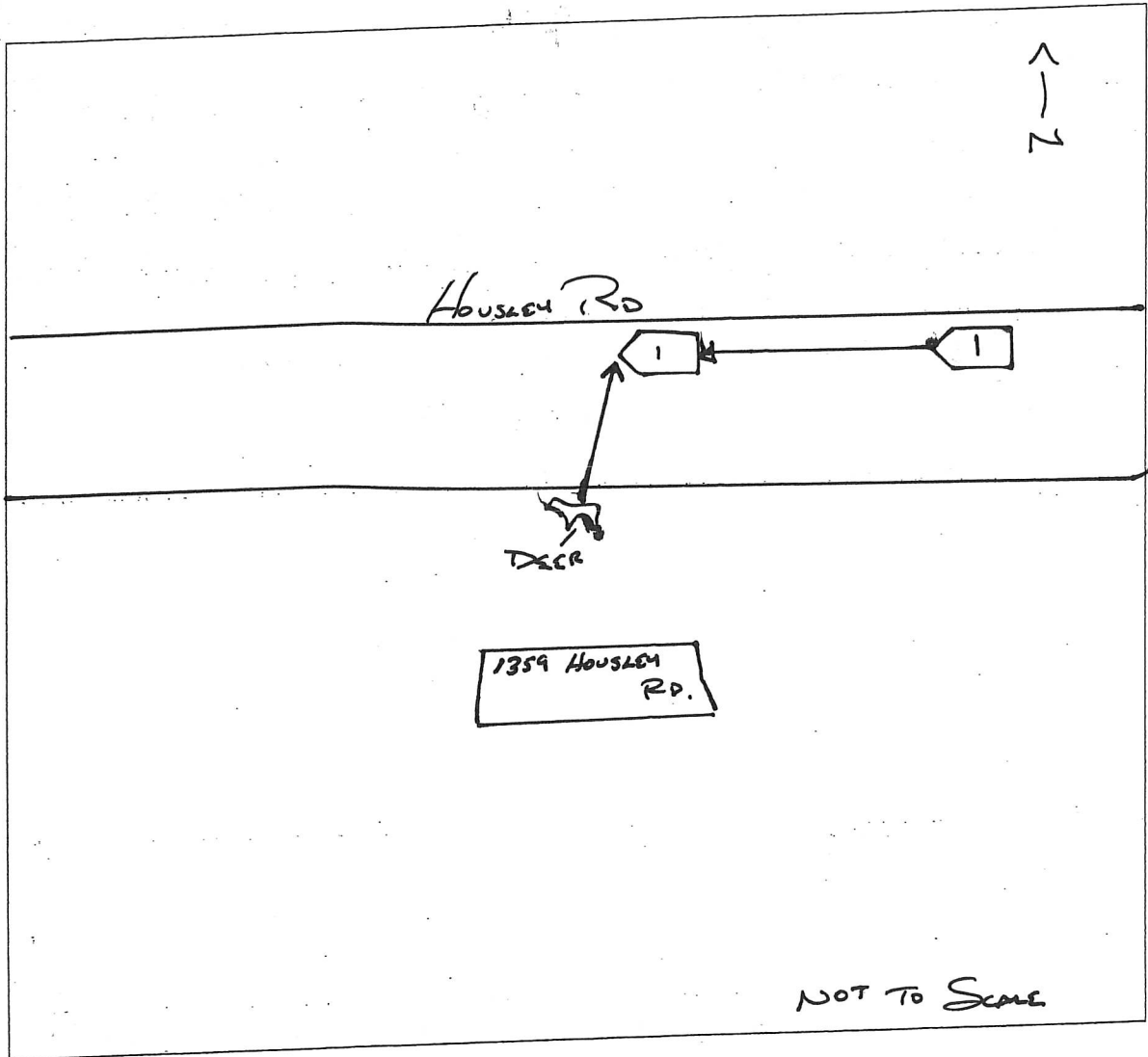

WEATHER

- CLEAR
- RAIN
- SNOW
- FOG
- OTHER

LIGHT

- DAYLIGHT
- DAWN
- DUSK
- DARK - LIGHTED ROAD
- DARK - NOT LIGHTED
- DARK - UNK LIGHTING
- UNKNOWN

SURFACE

- DRY
- WET
- SNOW
- ICE
- OTHER

ROAD

- CONCRETE
- BLACKTOP
- DIRT
- OTHER