



STOW POLICE DEPARTMENT

PRIVATE PROPERTY ACCIDENT REPORT/MINOR
TRAFFIC ACCIDENT REPORT

INCIDENT NUMBER **25-02042**
DATE **1/13/25** TIME **0650**

Private Property Private Property - Hit/Skip Minor Traffic Accident

LOCATION - ADDRESS **Fairfield 4170 Steels Pointe Stow OH 44224**

DRIVER #1 - NAME (Last, First, Middle) _____ PHONE _____

ADDRESS _____ CITY _____ STATE _____ ZIP _____

SSN _____ DATE OF BIRTH _____ DRIVER'S LICENSE NUMBER _____ STATE _____

OWNER #1 - NAME (Last, First, Middle) SAME AS DRIVER #1 PHONE **330-940-1450**

ADDRESS **4170 Steels Pointe** CITY **Stow** STATE **OH** ZIP **44224**

SSN _____ DATE OF BIRTH _____ DRIVER'S LICENSE NUMBER _____ STATE _____

VEHICLE LICENSE# _____ STATE _____ YEAR _____ MAKE _____ MODEL _____ COLOR _____

INSURANCE COMPANY _____ POLICY NUMBER _____

PARTS OF VEHICLE DAMAGED **Decorative stone work** CONTRIBUTING CIRCUMSTANCES _____

DRIVER #2 - NAME (Last, First, Middle) **Ross Jr, Terry** PHONE **216-338-6842**

ADDRESS **21750 Nicholas Ave** CITY **Euclid** STATE **OH** ZIP **44123**

SSN _____ DATE OF BIRTH **3/3/88** DRIVER'S LICENSE NUMBER _____ STATE **OH**

OWNER #2 - NAME (Last, First, Middle) SAME AS DRIVER #2 PHONE _____

ADDRESS **New Bern Transport Corp (Pepsi-Cola)** CITY **Twinsburg** STATE **OH** ZIP **44087**

SSN _____ DATE OF BIRTH _____ DRIVER'S LICENSE NUMBER _____ STATE _____

VEHICLE LICENSE # **PJX9058** STATE **OH** YEAR **2018** MAKE **Freightliner** MODEL **M2** COLOR **Unk**

INSURANCE COMPANY **Ace American Insurance** POLICY NUMBER **ISA H11348348**

PARTS OF VEHICLE DAMAGED **Driver's side of trailer** CONTRIBUTING CIRCUMSTANCES **Failure To Control**

DESCRIBE WHAT HAPPENED **Veh#2, a Pepsi delivery truck, was driving in front of the main entrance to Fairfield Inn & Suites in the parking lot when the driver's side of the trailer struck the stone work around a pillar which supports the front awning.**

Damaged trailer: Make: **Mickey Truck Bodies Inc** License Plate: **4757T (KY)**
Owner: **New Bern Transport Corp**
4008 Crittendon Dr Louisville KY

See Reverse Side for Diagram

SUBMITTED BY: **Pic B. Haddix #736** DATE **2/4/25**

APPROVING OFFICER: **SA J. J. #717** DATE **2-7-25**

Property

VEHICLE #1

VEHICLE #2

STOW POLICE DEPARTMENT

FIELD SKETCH (not drawn to scale)

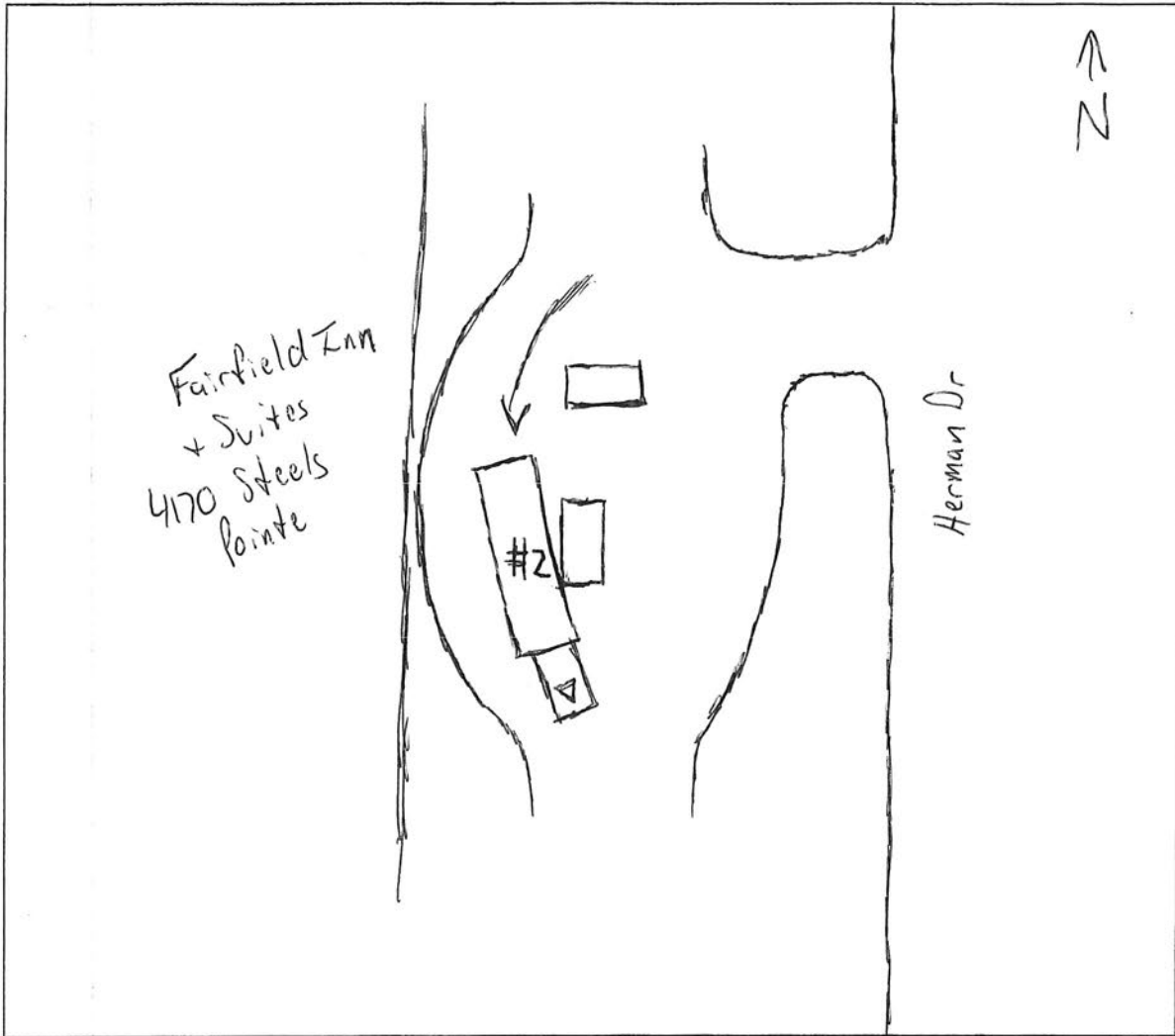

WEATHER

- CLEAR
- RAIN
- SNOW
- FOG
- OTHER

UNK

LIGHT

- DAYLIGHT
- DAWN
- DUSK
- DARK - LIGHTED ROAD
- DARK - NOT LIGHTED
- DARK - UNK LIGHTING
- UNKNOWN

SURFACE

- DRY
- WET
- SNOW
- ICE
- OTHER

UNK

ROAD

- CONCRETE
- BLACKTOP
- DIRT
- OTHER