



STOW POLICE DEPARTMENT

PRIVATE PROPERTY ACCIDENT REPORT/MINOR TRAFFIC ACCIDENT REPORT

INCIDENT NUMBER **25-01750**
 DATE **01-30-25** TIME **1830**

Private Property Private Property - Hit/Skip Minor Traffic Accident

LOCATION - ADDRESS **4399 Kent Rd**

DRIVER #1 - NAME (Last, First, Middle) **Breehl, William** PHONE **330 285 4310**

ADDRESS **2899 Heatherwood Ct** CITY **Stow** STATE **OH** ZIP **44224**

SSN [REDACTED] DATE OF BIRTH **01-07-1955** DRIVER'S LICENSE NUMBER [REDACTED] STATE **OH**

OWNER #1 - NAME (Last, First, Middle) SAME AS DRIVER #1 PHONE

ADDRESS CITY STATE ZIP

SSN DATE OF BIRTH DRIVER'S LICENSE NUMBER STATE

VEHICLE LICENSE# **JLW 2509** STATE **OH** YEAR **2018** MAKE **Toyota** MODEL **Avalon** COLOR **gray**

INSURANCE COMPANY **unk** POLICY NUMBER

PARTS OF VEHICLE DAMAGED **front bumper skin + undercarriage** CONTRIBUTING CIRCUMSTANCES **Full time + Attention**

DRIVER #2 - NAME (Last, First, Middle) PHONE

ADDRESS CITY STATE ZIP

SSN DATE OF BIRTH DRIVER'S LICENSE NUMBER STATE

OWNER #2 - NAME (Last, First, Middle) SAME AS DRIVER #2 PHONE

ADDRESS CITY STATE ZIP

SSN DATE OF BIRTH DRIVER'S LICENSE NUMBER STATE

VEHICLE LICENSE # STATE YEAR MAKE MODEL COLOR

INSURANCE COMPANY POLICY NUMBER

PARTS OF VEHICLE DAMAGED CONTRIBUTING CIRCUMSTANCES

DESCRIBE WHAT HAPPENED

Unit 1 drove into a fenced construction zone and became stuck in 4-6 inches of snow + water melt.

Unit 1 had to be winched out by Joe's Towing.

See Reverse Side for Diagram

SUBMITTED BY **[Signature]** DATE **01-31-25**

APPROVING OFFICER: **[Signature]** 719 DATE **1-31-25**

STOW POLICE DEPARTMENT

FIELD SKETCH (not drawn to scale)

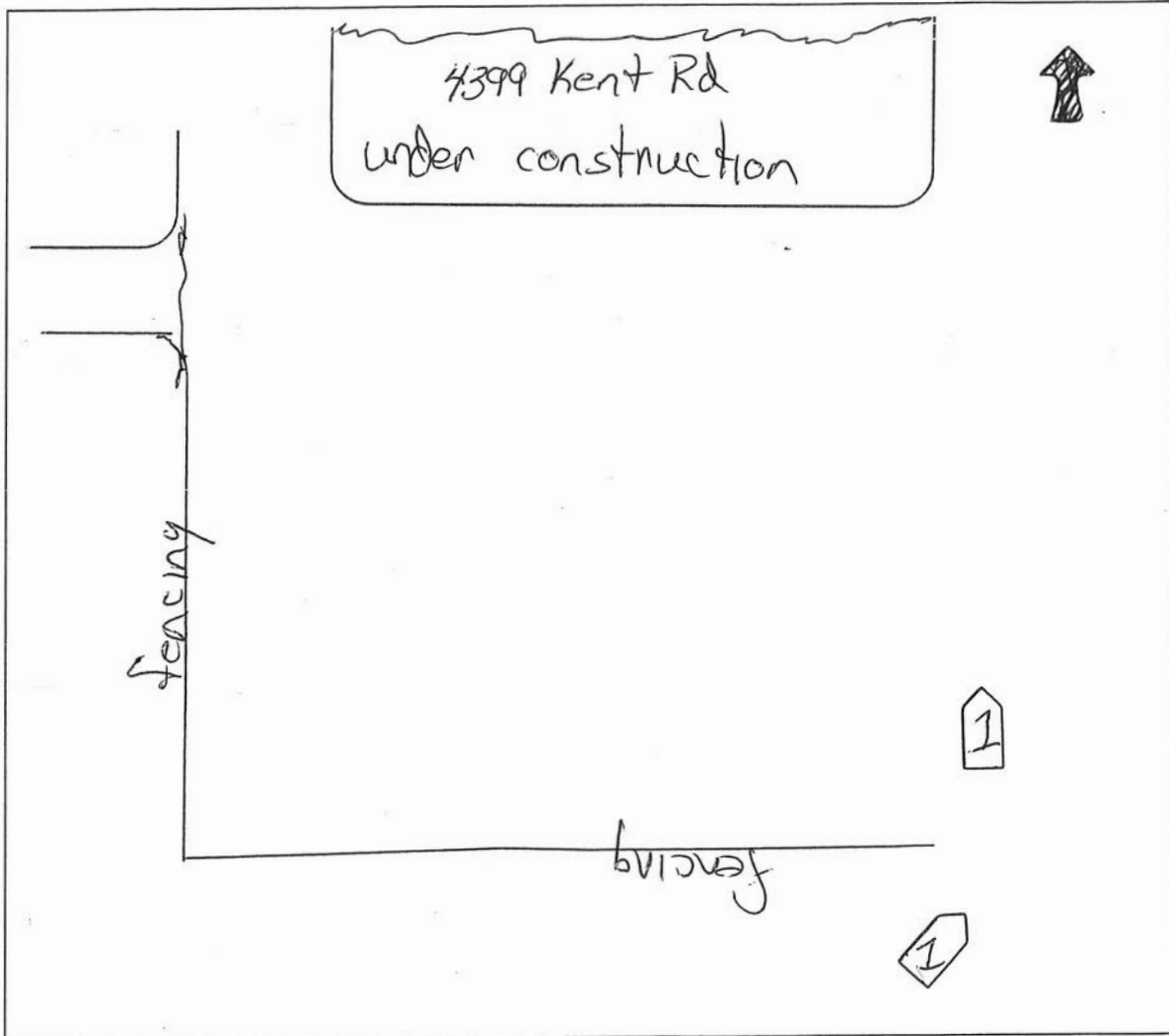

WEATHER

- CLEAR
- RAIN
- SNOW
- FOG
- OTHER

LIGHT

- DAYLIGHT
- DAWN
- DUSK
- DARK - LIGHTED ROAD
- DARK - NOT LIGHTED
- DARK - UNK LIGHTING
- UNKNOWN

SURFACE

- DRY
- WET
- SNOW
- ICE
- OTHER

ROAD

- CONCRETE
- BLACKTOP
- DIRT
- OTHER