



# STOW POLICE DEPARTMENT

PRIVATE PROPERTY ACCIDENT REPORT/MINOR  
TRAFFIC ACCIDENT REPORT

INCIDENT NUMBER **20-03023**  
DATE **02/17/20** TIME **1224**

Private Property  Private Property - Hit/Skip  Minor Traffic Accident

LOCATION - ADDRESS **3806 Wyndham Rdg**

VEHICLE #1

DRIVER #1 - NAME (Last, First, Middle) **Smith, Dustin C** PHONE [REDACTED]  
ADDRESS **3820 Wyndham Rdg # 205** CITY **Stow** STATE **OH** ZIP **44224**  
SSN [REDACTED] DATE OF BIRTH **4/14/81** DRIVER'S LICENSE NUMBER [REDACTED] STATE **OH**

OWNER #1 - NAME (Last, First, Middle)  SAME AS DRIVER #1 PHONE [REDACTED]  
ADDRESS [REDACTED] CITY [REDACTED] STATE [REDACTED] ZIP [REDACTED]  
SSN [REDACTED] DATE OF BIRTH [REDACTED] DRIVER'S LICENSE NUMBER [REDACTED] STATE [REDACTED]  
VEHICLE LICENSE# **HTE 9581** STATE **OH** YEAR **07** MAKE **Dodge** MODEL **1.20m 1500** COLOR **gray**  
INSURANCE COMPANY **Grange** POLICY NUMBER **9969736**

PARTS OF VEHICLE DAMAGED **front bumper** CONTRIBUTING CIRCUMSTANCES **FTY**

VEHICLE #2

DRIVER #2 - NAME (Last, First, Middle) **Nyenhuis, Benjamin David** PHONE [REDACTED]  
ADDRESS **3850 Wyndham Rdg # 208** CITY **Stow** STATE **OH** ZIP **44224**  
SSN [REDACTED] DATE OF BIRTH **11/15/93** DRIVER'S LICENSE NUMBER [REDACTED] STATE **OH**

OWNER #2 - NAME (Last, First, Middle)  SAME AS DRIVER #2 PHONE [REDACTED]  
ADDRESS [REDACTED] CITY [REDACTED] STATE [REDACTED] ZIP [REDACTED]  
SSN [REDACTED] DATE OF BIRTH [REDACTED] DRIVER'S LICENSE NUMBER [REDACTED] STATE [REDACTED]  
VEHICLE LICENSE # **HLW1458** STATE **OH** YEAR **2016** MAKE **Hyundai** MODEL **Accent** COLOR **gray**  
INSURANCE COMPANY **State Farm** POLICY NUMBER **988 2693 E21 35**

PARTS OF VEHICLE DAMAGED **Pass front 1/4** CONTRIBUTING CIRCUMSTANCES **nonP**

DESCRIBE WHAT HAPPENED **Unit #1 was SB in parking lot btw two complex garages. Unit #2 was WB in parking lot. Unit #1 attempted to pull out from in between garages to go EB. Unit #2 struck unit #1.**

See Reverse Side for Diagram

SUBMITTED BY: **[Signature] Molody 734** DATE **2/17/20**  
APPROVING OFFICER: **[Signature]** DATE **2/17/20**

# STOW POLICE DEPARTMENT

## FIELD SKETCH (not drawn to scale)

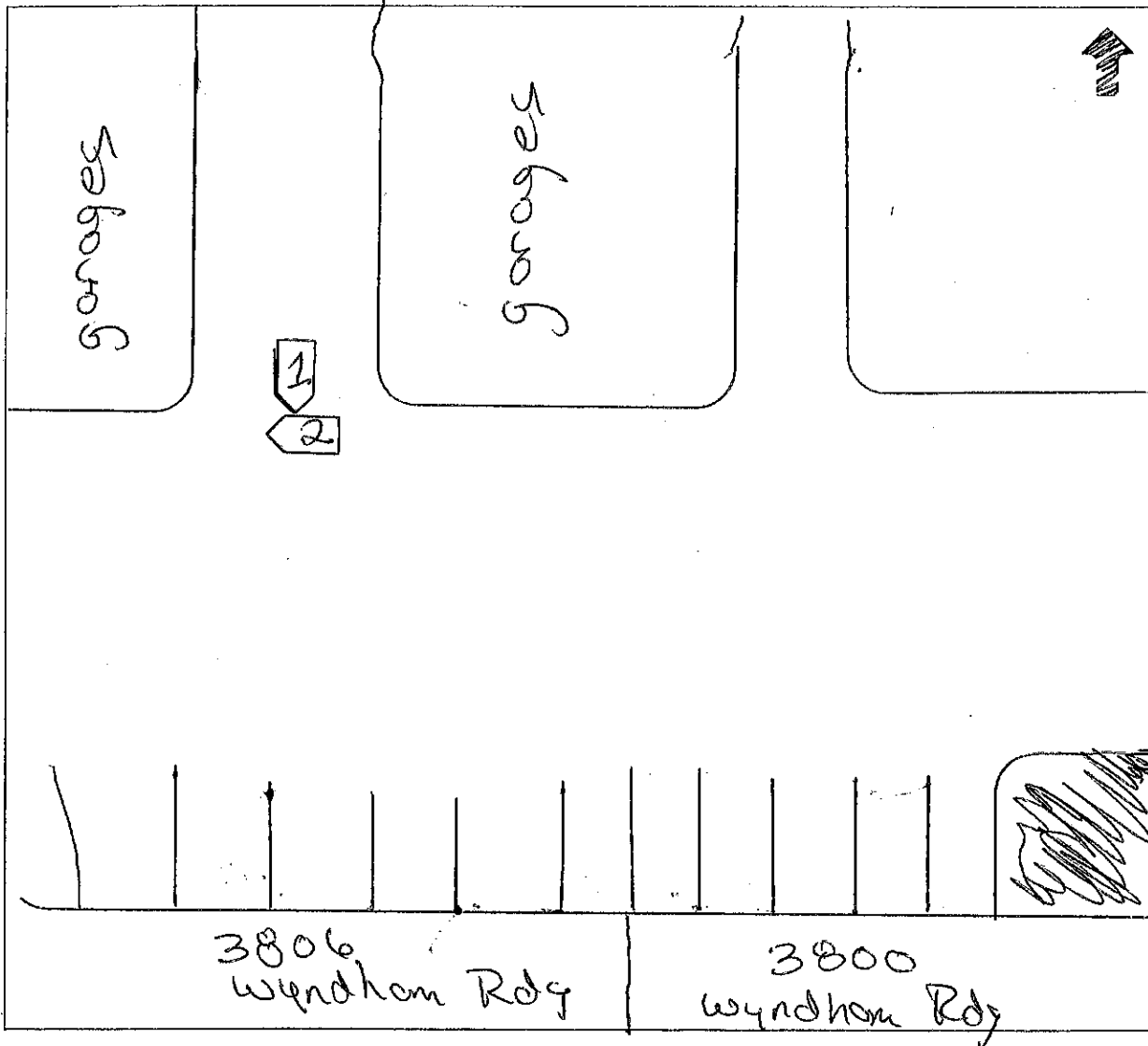

### WEATHER

- CLEAR
- RAIN
- SNOW
- FOG
- OTHER

### LIGHT

- DAYLIGHT
- DAWN
- DUSK
- DARK - LIGHTED ROAD
- DARK - NOT LIGHTED
- DARK - UNK LIGHTING
- UNKNOWN

### SURFACE

- DRY
- WET
- SNOW
- ICE
- OTHER

### ROAD

- CONCRETE
- BLACKTOP
- DIRT
- OTHER