



STOW POLICE DEPARTMENT

PRIVATE PROPERTY ACCIDENT REPORT/MINOR
TRAFFIC ACCIDENT REPORT

INCIDENT NUMBER

20-02973

DATE

2-16-20

TIME

1345

Private Property Private Property - Hit/Skip Minor Traffic Accident

LOCATION - ADDRESS

4030 Wyndham Ridge Drive

DRIVER #1 - NAME (Last, First, Middle)

Nichols, Cheryl E.

PHONE

ADDRESS

CITY

Stow

STATE

OH

ZIP

44224

SSN

DATE OF BIRTH

5-22-89

DRIVER'S LICENSE NUMBER

STATE

OH

VEHICLE #1

OWNER #1 - NAME (Last, First, Middle)

SAME AS DRIVER #1

PHONE

ADDRESS

CITY

STATE

ZIP

SSN

DATE OF BIRTH

DRIVER'S LICENSE NUMBER

STATE

VEHICLE LICENSE#

HSK 7226

STATE

OH

YEAR

2017

MAKE

Honda

MODEL

Civic

COLOR

Silver

INSURANCE COMPANY

Progressive

POLICY NUMBER

928185100

PARTS OF VEHICLE DAMAGED

scraping/indentation all along middle/rear of d/s

CONTRIBUTING CIRCUMSTANCES

None - parked/unoccupied

VEHICLE #2

DRIVER #2 - NAME (Last, First, Middle)

unknown

PHONE

ADDRESS

CITY

STATE

ZIP

SSN

DATE OF BIRTH

DRIVER'S LICENSE NUMBER

STATE

OWNER #2 - NAME (Last, First, Middle)

SAME AS DRIVER #2

PHONE

ADDRESS

CITY

STATE

ZIP

SSN

DATE OF BIRTH

DRIVER'S LICENSE NUMBER

STATE

VEHICLE LICENSE #

STATE

YEAR

MAKE

MODEL

COLOR

INSURANCE COMPANY

POLICY NUMBER

PARTS OF VEHICLE DAMAGED

CONTRIBUTING CIRCUMSTANCES

Failure to Control - hit parked car

DESCRIBE WHAT HAPPENED

Unit 1 stated she parked her car in front of 4030 Wyndham Ridge on 2-15-20 at approximately 1928 hours. The next day, 2-16-20 at approximately 1330 hours, she observed fresh damage to her car. I observed the scraping and indentations along the rear and middle of the driver-side of Unit 1 do appear to have occurred there (scraping lineation on the tire match up with body scraping, indicating Unit 1 had not been moved since the damage occurred). It is likely Unit 2 pulled forward into the yellow striped no-parking zone next to Unit 1 and the front passenger-side of Unit 2 (unknown) struck the driver-side of Unit 1.

See Reverse Side for Diagram

SUBMITTED BY:

Ginther, F31

DATE

2-16-20

APPROVING OFFICER:

Sgt. Dan C 208

DATE

2/17/20

STOW POLICE DEPARTMENT

FIELD SKETCH (not drawn to scale)

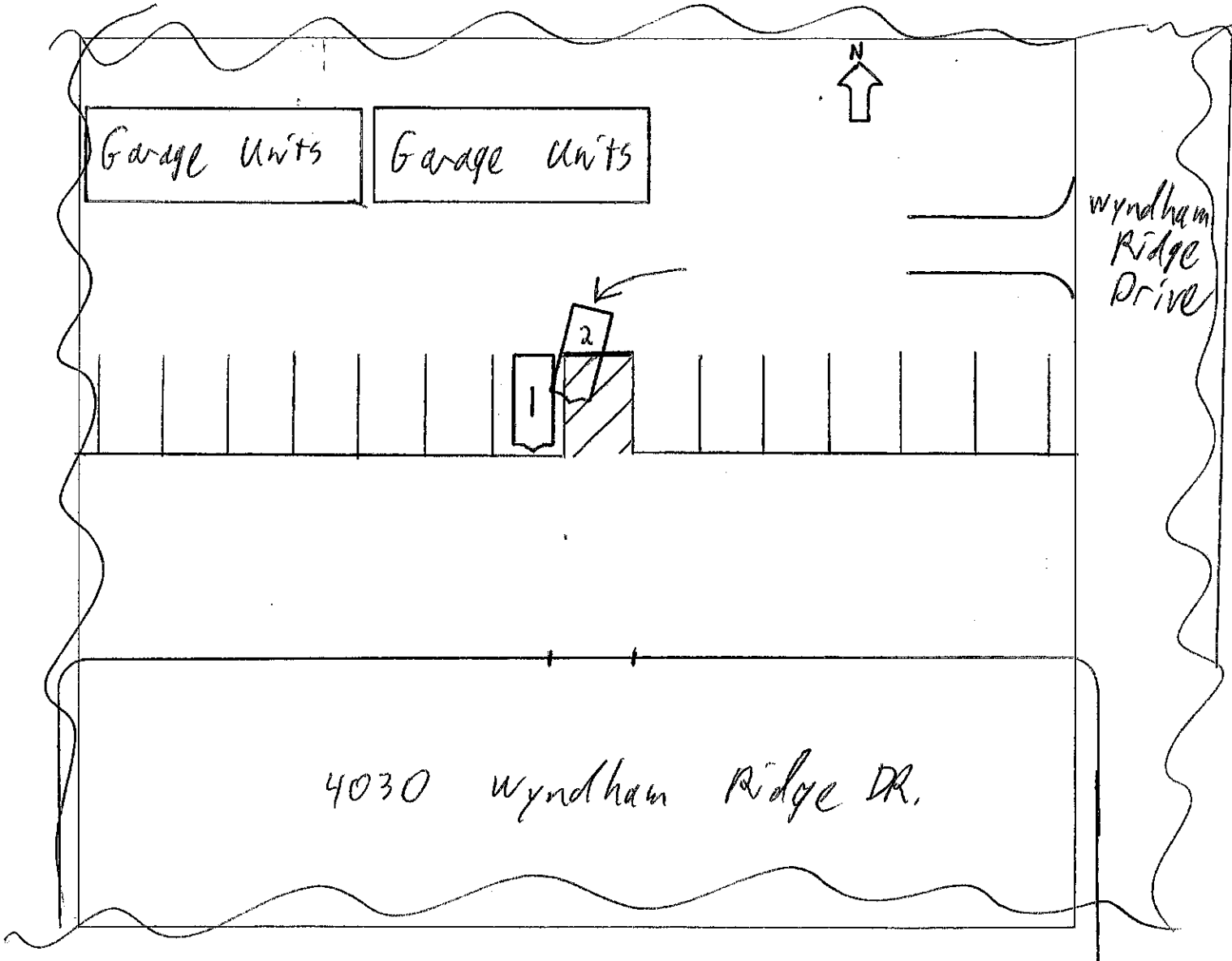

WEATHER

- CLEAR
- RAIN
- SNOW
- FOG
- OTHER

LIGHT

- DAYLIGHT
- DAWN
- DUSK
- DARK - LIGHTED ROAD
- DARK - NOT LIGHTED
- DARK - UNK LIGHTING
- UNKNOWN

SURFACE

- DRY
- WET
- SNOW
- ICE
- OTHER

ROAD

- CONCRETE
- BLACKTOP
- DIRT
- OTHER