



# STOW POLICE DEPARTMENT

PRIVATE PROPERTY ACCIDENT REPORT/MINOR  
TRAFFIC ACCIDENT REPORT

INCIDENT NUMBER  
**24-18652**

DATE  
**12-1-24**

TIME  
**0948**

Private Property    Private Property - Hit/Skip    Minor Traffic Accident

LOCATION - ADDRESS  
**4303 KENT RD (MEIJER)**

DRIVER #1 - NAME (Last, First, Middle)   PHONE  
**UNOCCUPIED - PARKED**

ADDRESS   CITY   STATE   ZIP

SSN   DATE OF BIRTH   DRIVER'S LICENSE NUMBER   STATE

VEHICLE #1

OWNER #1 - NAME (Last, First, Middle)    SAME AS DRIVER #1   PHONE  
**ADAMS, ANDREW**   **330-614-6030**

ADDRESS   CITY   STATE   ZIP  
**13723 LOUISVILLE ST NE**   **PARIS**   **OH**   **44669**

SSN   DATE OF BIRTH   DRIVER'S LICENSE NUMBER   STATE  
[REDACTED]   **9-24-98**   [REDACTED]   **OH**

VEHICLE LICENSE #   STATE   YEAR   MAKE   MODEL   COLOR  
**JTX2562**   **OH**   **2006**   **TOYOTA**   **COROLLA**   **RED**

INSURANCE COMPANY   POLICY NUMBER  
**NO INSURANCE**

PARTS OF VEHICLE DAMAGED   CONTRIBUTING CIRCUMSTANCES  
**FRONT BUMPER**   **N/A**

DRIVER #2 - NAME (Last, First, Middle)   PHONE  
**BORTAS, ROLANDO L.**   **330-592-0269**

ADDRESS   CITY   STATE   ZIP  
**1516 LAKEMOOD RD**   **COVENTRY TWP**   **OH**   **44203**

SSN   DATE OF BIRTH   DRIVER'S LICENSE NUMBER   STATE  
[REDACTED]   **9-29-74**   [REDACTED]   **OH**

VEHICLE #2

OWNER #2 - NAME (Last, First, Middle)    SAME AS DRIVER #2   PHONE

ADDRESS   CITY   STATE   ZIP

SSN   DATE OF BIRTH   DRIVER'S LICENSE NUMBER   STATE

VEHICLE LICENSE #   STATE   YEAR   MAKE   MODEL   COLOR  
**HN115746**   **OH**   **2018**   **GMC**   **SIERRA**   **BLACK**

INSURANCE COMPANY   POLICY NUMBER  
**AMERICAN SELECT INS.**   **WMP221633T**

PARTS OF VEHICLE DAMAGED   CONTRIBUTING CIRCUMSTANCES  
**P/S OF TRUCK**   **FAILURE TO CONTROL.**

DESCRIBE WHAT HAPPENED  
**WHILE PULLING OUT OF A PARKING SPACE UNIT 2  
STUCK UNIT 1 WHICH WAS PARKED THE FRONT  
BUMPER OF UNIT 1 WAS PULLED OFF.**

See Reverse Side for Diagram

SUBMITTED BY:   DATE  
**[Signature]** #747   **12-1-24**

APPROVING OFFICER:   DATE  
**Ginter, 715**   **12-1-24**

# STOW POLICE DEPARTMENT

FIELD SKETCH (not drawn to scale)

NORTH ↑

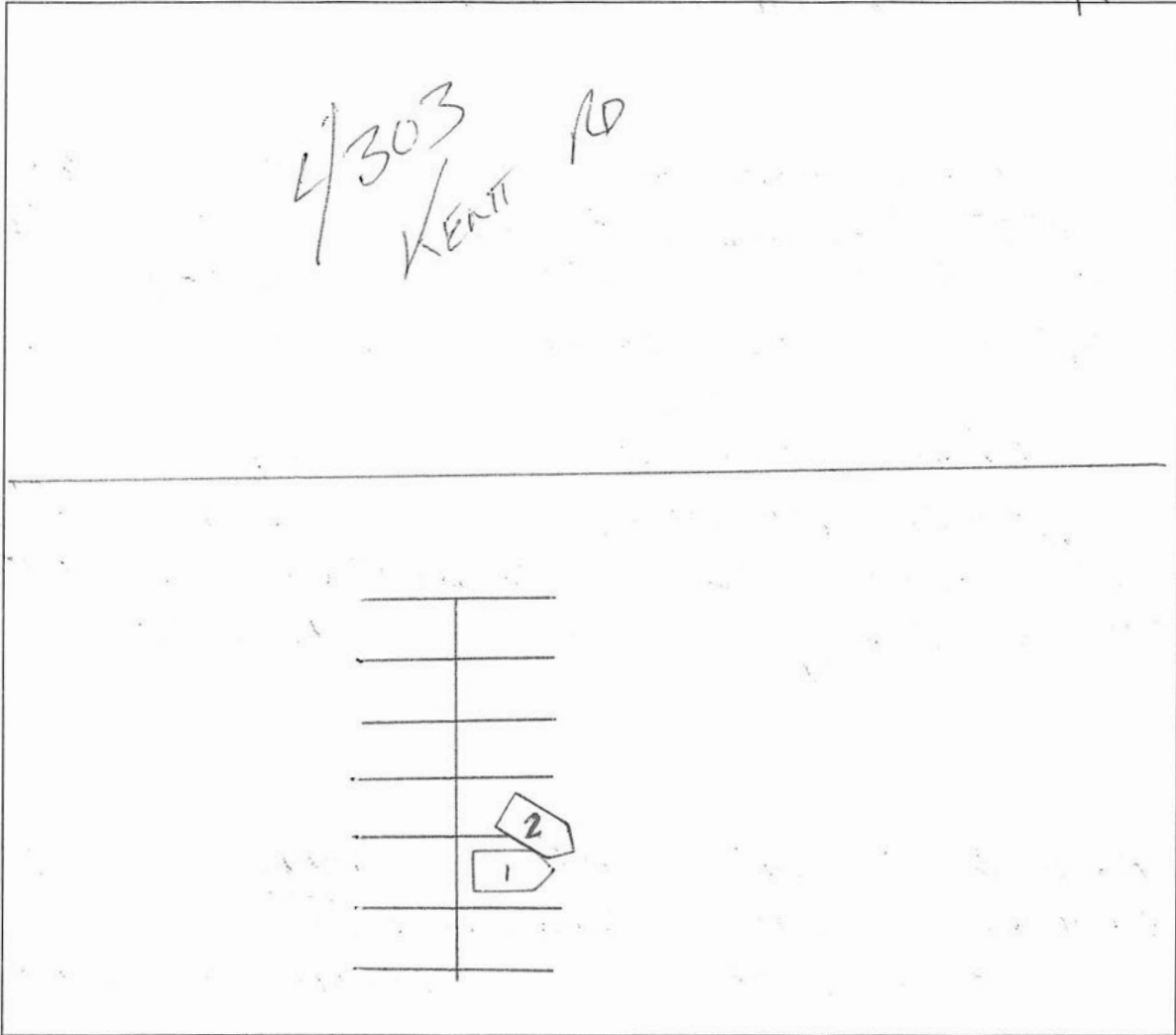

## WEATHER

- CLEAR
- RAIN
- SNOW
- FOG
- OTHER

## LIGHT

- DAYLIGHT
- DAWN
- DUSK
- DARK - LIGHTED ROAD
- DARK - NOT LIGHTED
- DARK - UNK LIGHTING
- UNKNOWN

## SURFACE

- DRY
- WET
- SNOW
- ICE
- OTHER

## ROAD

- CONCRETE
- BLACKTOP
- DIRT
- OTHER