



STOW POLICE DEPARTMENT

PRIVATE PROPERTY ACCIDENT REPORT/MINOR TRAFFIC ACCIDENT REPORT

INCIDENT NUMBER
24-17554

DATE
11/11/24

TIME
1418

Private Property Private Property - Hit/Skip Minor Traffic Accident

LOCATION - ADDRESS
4240 HUDSON DR.

DRIVER #1 - NAME (Last, First, Middle) PHONE
BARTON, PAMELA S. 330-304-2958

ADDRESS CITY STATE ZIP
4119 ROANOKE DR. BRUNSWICK OH 44212

SSN DATE OF BIRTH DRIVER'S LICENSE NUMBER STATE
[REDACTED] 9-4-68 [REDACTED] OH

VEHICLE #1

OWNER #1 - NAME (Last, First, Middle) SAME AS DRIVER #1 PHONE

ADDRESS CITY STATE ZIP

SSN DATE OF BIRTH DRIVER'S LICENSE NUMBER STATE

VEHICLE LICENSE# STATE YEAR MAKE MODEL COLOR
H668984 OH 2024 FORD EDGE BLK

INSURANCE COMPANY POLICY NUMBER
STATE FARM 3689395-SF-35

PARTS OF VEHICLE DAMAGED CONTRIBUTING CIRCUMSTANCES
REAR NONE

DRIVER #2 - NAME (Last, First, Middle) PHONE
OLSON, JEFFREY D. 440-351-9041

ADDRESS CITY STATE ZIP
7672 KENT RD. # 51 STOW OH 44224

SSN DATE OF BIRTH DRIVER'S LICENSE NUMBER STATE
[REDACTED] 11-2-63 [REDACTED] OH

VEHICLE #2

OWNER #2 - NAME (Last, First, Middle) SAME AS DRIVER #2 PHONE

ADDRESS CITY STATE ZIP

SSN DATE OF BIRTH DRIVER'S LICENSE NUMBER STATE

VEHICLE LICENSE # STATE YEAR MAKE MODEL COLOR
KLT9048 OH 2015 GMC TRUCK BLK

INSURANCE COMPANY POLICY NUMBER
EMIE Q108110215

PARTS OF VEHICLE DAMAGED CONTRIBUTING CIRCUMSTANCES
REAR BACKING.

DESCRIBE WHAT HAPPENED

UNIT # 1 PARKED, PRIVATE LOT OF 4240 HUDSON FACING SOUTH.

UNIT # 2 BACKED OUT OF SPACE AND STRUCK UNIT # 1.

See Reverse Side for Diagram

SUBMITTED BY: DATE
OFC. S. WILLIAMS JFC 11-11-24

APPROVING OFFICER: DATE
Ginther, 715 11-17-24

STOW POLICE DEPARTMENT

FIELD SKETCH (not drawn to scale)

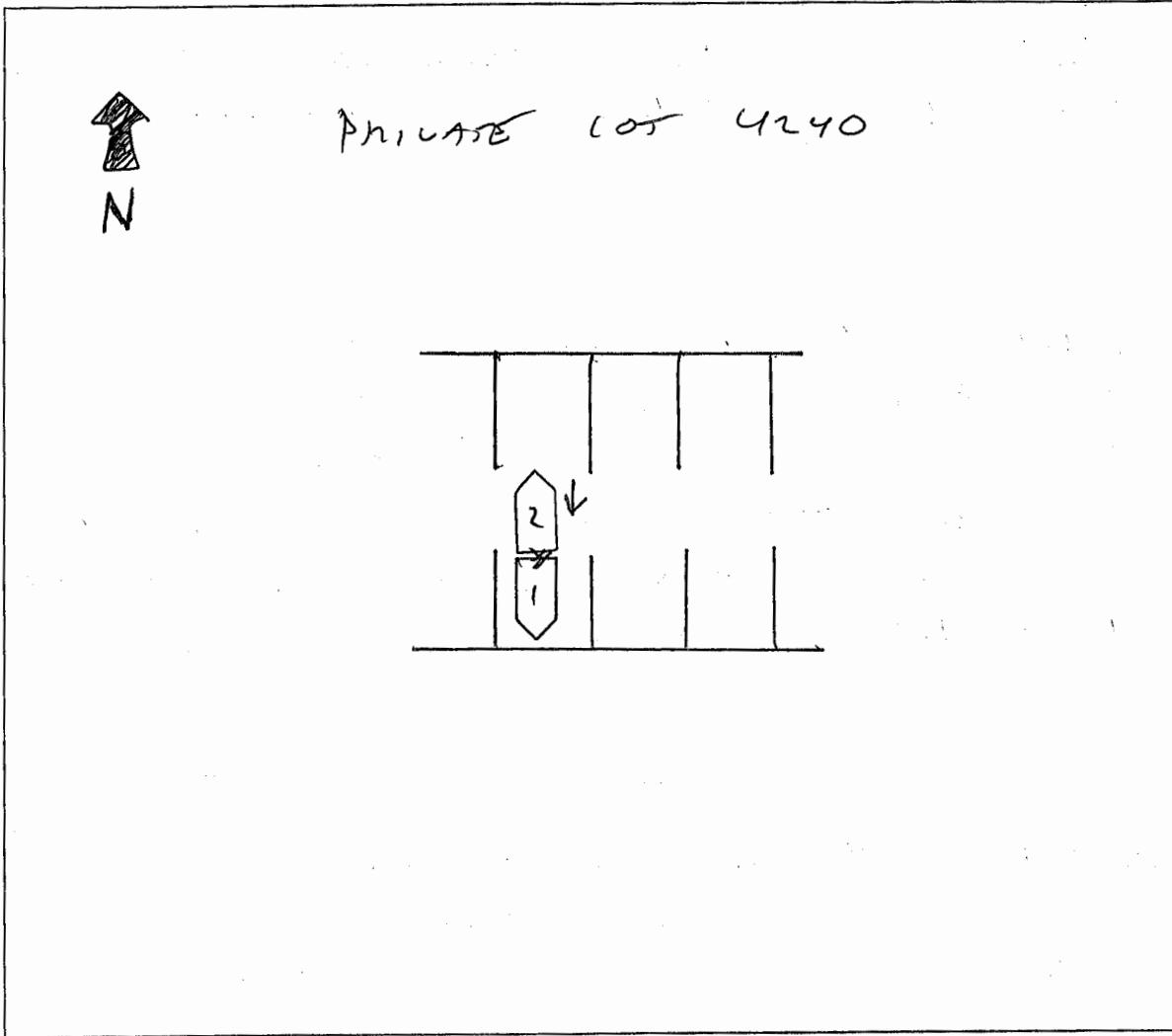

WEATHER

- CLEAR
- RAIN
- SNOW
- FOG
- OTHER

LIGHT

- DAYLIGHT
- DAWN
- DUSK
- DARK - LIGHTED ROAD
- DARK - NOT LIGHTED
- DARK - UNK LIGHTING
- UNKNOWN

SURFACE

- DRY
- WET
- SNOW
- ICE
- OTHER

ROAD

- CONCRETE
- BLACKTOP
- DIRT
- OTHER

LOCAL REPORT NUMBER 24-17554	REPORTING AGENCY STOW PD	DATE OF CRASH M 11 D 11 Y 24
---------------------------------	-----------------------------	-------------------------------------



FOR LOCAL USE ONLY - DO NOT SUBMIT TO THE STATE EXCEPT FOR FATAL CRASHES

I, LAUREN CRAPSADLE HEREBY MAKE THIS VOLUNTARY STATEMENT TO
PRINTED

S. WILLIAMS AT 4240 HUDSON DR
OFFICER'S NAME LOCATION

was walking into ROCKETS and heard a
 CRASH. turned around and seen that black
 TRUCK backed INTO a black Ford edge. Driver
 of truck pulled INTO a spot and then walked
 around Ford edge, got back in truck and
 left. I notified STAFF of above @ ROCKETS.

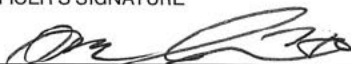
 330-491-7735

ADDRESS OF WITNESS 4010 PELHAM ST. CANTON, OH 44714	OFFICER'S SIGNATURE X 
SIGNATURE OF WITNESS X 	



LOCAL REPORT NUMBER 24-17554	REPORTING AGENCY Stow PD	DATE OF CRASH M 11 D 11 Y 24
---------------------------------	-----------------------------	-------------------------------------

FOR LOCAL USE ONLY - DO NOT SUBMIT TO THE STATE EXCEPT FOR FATAL CRASHES

I, Jeff Olson HEREBY MAKE THIS VOLUNTARY STATEMENT TO
PRINTED

OFC GABEL 760 AT 3672 KENT RO. APT 51 STOW, OH
OFFICER'S NAME LOCATION

* Went to Rockvees to pick up Lunch for staff, came out & Bumped car Behind Me. Saw people Look, waved & pulled over to check - Saw NO DAMAGES OR S.O.I.Y on Mine. figured ok & left Before Lunch got cold

ADDRESS OF WITNESS 3672 KENT RO. APT 51 STOW, OH 44224	PHONE 440-331-9841
SIGNATURE OF WITNESS X <u>Jeff Olson</u>	OFFICER'S SIGNATURE X <u>OFC. DR GABEL 760</u>